



## RAIL POST INSULATOR

**BBI 70**  
Up to 7.2kV



### Application

For use in outdoor railway standoff applications.

### Design

Moulded solid core outdoor PH-CEP\* hydrophobic cycloaliphatic epoxy resin rail post insulator.

### Standards

EMC Pacific post insulators meet the Polymeric Resin Insulator requirements of IEC & AS 62217 and the relevant requirements of AS 4398 and IEC 60168.

### Quality

Each insulator is put through stringent quality assurance in line with the EMC Pacific ISO9001 Quality Management System.

Manufactured in Australia by EMC Pacific Pty Ltd, Dandenong, Victoria.

Specification and product design are subject to change without notice. All Information is accurate at time of printing.

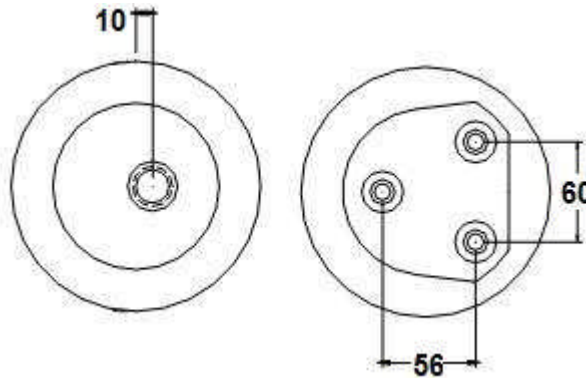

### Specification

\*Permanent Hydrophobic Cycloaliphatic Epoxy Resin (patent applied)

|  |                      |
|--|----------------------|
| Product No                                 | BBI 70               |
| Highest Voltage for Equipment (kV)         | 7.2 kV               |
| Line Voltage (kV)                          | 6.6 kV               |
| Impulse Withstand Voltage (kV)             | 40 kV                |
| Dry Power Frequency Withstand Voltage (kV) | 16 kV                |
| Wet Power Frequency Withstand Voltage (kV) | 16 kV                |
| Dry Arc Distance (mm)                      | 85 mm                |
| Creepage (mm)                              | 155 mm               |
| Minimum Tensile failing load (kN)          | 10 kN                |
| Insulator Height                           | 70 mm                |
| Maximum Shed Diameter                      | 150 mm               |
| Brass Insert Sizes                         | 1 x 20 mm, 3 x 10 mm |
| Weight (kg)                                | 1 kg                 |